

90° Elbows - Threaded
150# Malleable Iron
 Inches / Pounds

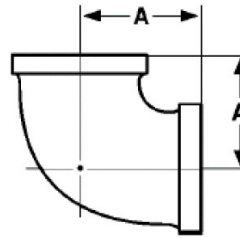

Part #	Size	A	Approximate Weight (in Lbs.)
K90E.125MI	1/8	0.69	0.10
K90E.25MI	1/4	0.81	0.10
K90E.375MI	3/8	0.95	0.20
K90E.5MI	1/2	1.12	0.20
K90E.75MI	3/4	1.31	0.30
K90E1MI	1	1.50	0.60
K90E1.25MI	1 1/4	1.75	0.90
K90E1.5MI	1 1/2	1.94	1.20
K90E2MI	2	2.25	1.80
K90E2.5MI	2 1/2	2.70	3.10
K90E3MI	3	3.08	3.90
K90E3.5MI	3 1/2	3.42	6.60
K90E4MI	4	3.79	7.50
K90E5MI	5	4.50	13.20
K90E6MI	6	5.13	19.80
K90E8MI	8	6.38	32.00

****Malleable Castings conform to ASTM A197***

****Malleable Fitting Dimensions conform to ASME B16.3***

****NPT Threads on all fittings conform to ASME B1.20.1***

****Class 150 fittings are UL listed and FM approved at 300 psi***